



Inspection Format

Cemetery ID: 10272

County: SURREY

Last Inspection Date: 09/07/2009

Overall Risk Assessment:

Cemetery Name: FARNHAM (UPPER HALE) CEMETERY

OS Map Ref: 186/838492

Works Features:

Category: 1

Order No	Casualty Name	Location	Marker	Material	Nationality	War	Add. Bur.	Main-tained	Remarks
10	WILLIAMS L R	UC.199	CH	Portland		WW1	0		Flat turf
20	PHILLIPS E J P	D.2830	CH	Portland		WW1	0		Flat turf
30	CAESAR H J	D.2812	CH/PM	Portland		WW1	1		CH, portland kerb, loose plaque (commemoration wife). Turf infill, Against railings
40	MILEHAM F E	D.2420	CH	Portland		WW2	0		CH, 2 grave space - 2 burials. No other memorial but CH. Turf infill
50	PAYNE Maud Rose	D.1772	CH	Portland		WW2	0		Flat turf
60	HYNER E W	D.17.1935	CH	Portland		WW1	0		Flat turf
70	NEWMAN E C	D.12.1996	CH	Portland		WW1	0		Flat turf
80	SAGGERS W T	D.14.1970	CH	Portland		WW1	0		Flat turf
90	NEWMAN S	D.17.1931	CH	Portland		WW1	0		Flat turf
100	LENNON J P	D.1900	PM			WW2	0		1'6" white marble headstone & kerb. Turf infill. 1 forward, 1 right (across path) of CH to NEWMAN S
110	SPREADBOROUGH H	D.14.1968	CH	Portland		WW1	0		Flat turf
120	GARDINER T	D.9.2029	CH	Portland		WW1	0		Flat turf
130	STOCK S C	D.8.2042	CH	Portland		WW1	0		Flat turf
140	TRIGG L	D.3.2011	CH	Portland		WW1	0		Flat turf
150	WILKINSON E W	D.2085	CH	Portland		WW1	0		Flat turf
160	AYRES W A	D.1724	CH	Portland		WW2	0		Flat turf
170	JAVES A T	D.15.2034	CH	Portland		WW1	0		Flat turf
180	WINSLADE A A	D.11.2002	CH	Portland		WW1	0		Flat turf
190	PHILO E H A	D.6.1991	CH	Portland		WW1	0		Flat turf
200	FOOT A J	D.4.2060	CH	Portland		WW1	0		Flat turf

FARNHAM (UPPER HALE) CEMETERY

SURREY

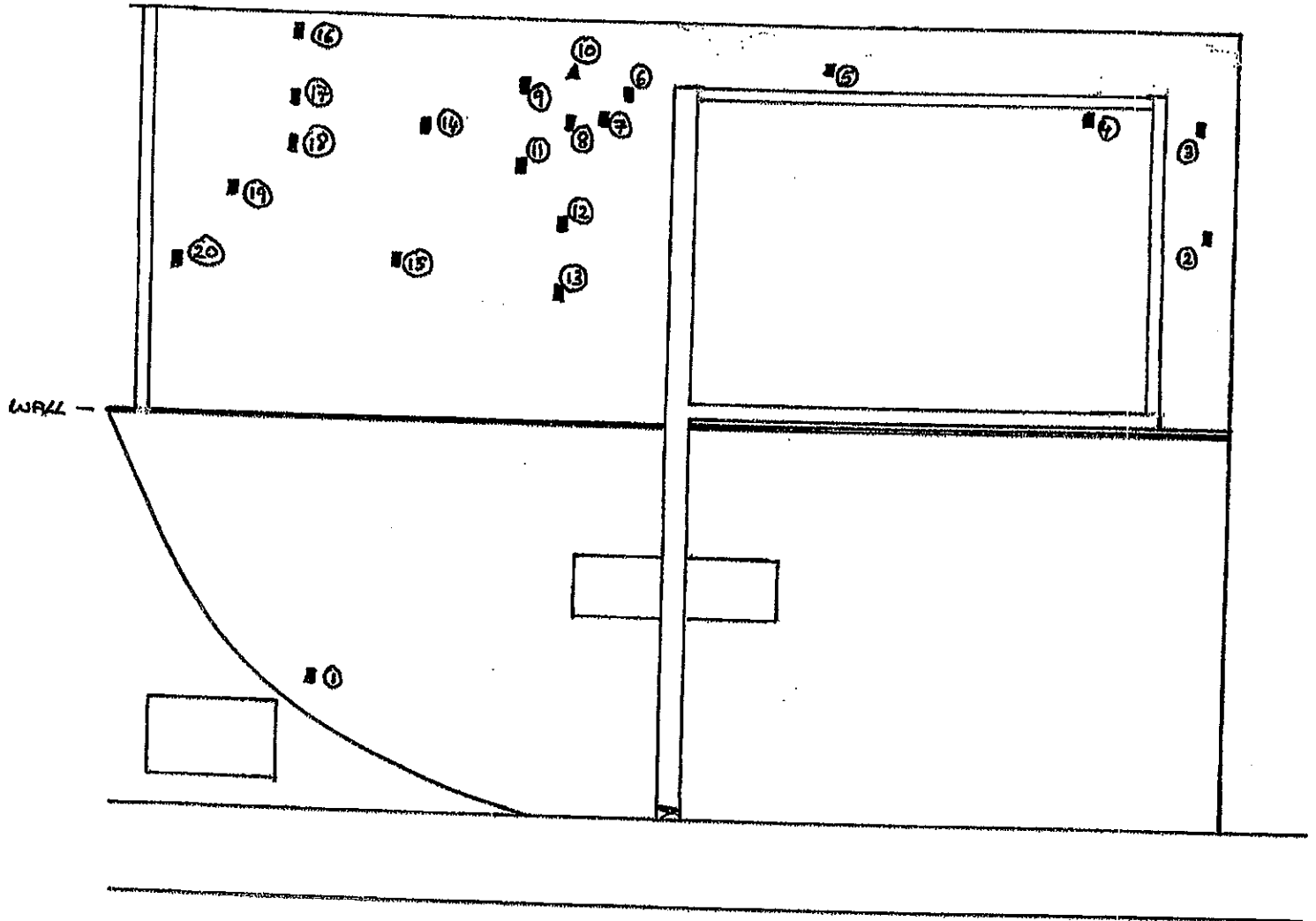



Inspection Format

Cemetery ID: 10273

County: SURREY

Last Inspection Date: 09/07/2009

Overall Risk Assessment:

Cemetery Name: FARNHAM (GREEN LANE) CEMETERY

OS Map Ref: 186/835453

Works Features:

Category: 1

Order

No	Casualty Name	Location	Marker	Material	Nationality	War	Add. Bur.	Main-tained	Remarks
10	KNIGHT F	A.516	CH	Portland		WW2	0		Turfed mound
20	COVINGTON A F	A.207	CH/PM	Portland		WW2	0		Portland kerb (un-inscribed). Turf infill
30	WARREN G J	A.157	CH	Portland		WW2	0		Flat turf
40	FRY O	B.672	CH/PM	Portland		WW1	1		PM foot of grave. Portland 2'. Turf mound
50	BARRETT F W	B.632	CH	Portland		WW1	0		Flat turf
60	MILES R W	B.981	CH/PM	Portland		WW2	0		Portland kerb, turf infill. (Kerb suffered damage by frost)
70	WILSON-STEELE E C S	B.1079	CH/PM	Portland		WW2	0		Portland kerb - turf infill. (Kerb disintegrating)
80	KILBURN M H J	B.1103	CH/PM	Portland		WW2	1		Portland kerb (inscribed Father) chippings. kerb fractured
90	GUNNING W J	B.1041	CH	Portland		WW2	0		Flat turf
100	PULLEN R T	B.1106	CH/PM	Portland		WW2	0		Portland kerb (uninscribed). Chippings. Flower Vase inscribed particulars of casualty. Kerb fractured.
110	FORD L A	B.1009	PM			WW2	1		Grey granite 1'6" headstone and kerb. Chippings. 1 right, 4 back of CH PULLEN (pathside).
120	PEARCE A E	B.1241	PM			WW2	0		2' york headstone & kerb, flat turf, 7 rows forward, 2 right of CH to KILBURN
130	LYFORD E	B.1262	PM			WW2	1		1'6" grey granite headstone and kerb. Chippings. (Wife added - Elsie Gladys - 19.10.68). 8F of CH to KILBURN

10273

FARNHAM (GREEN LANE) CEMETERY

SURREY

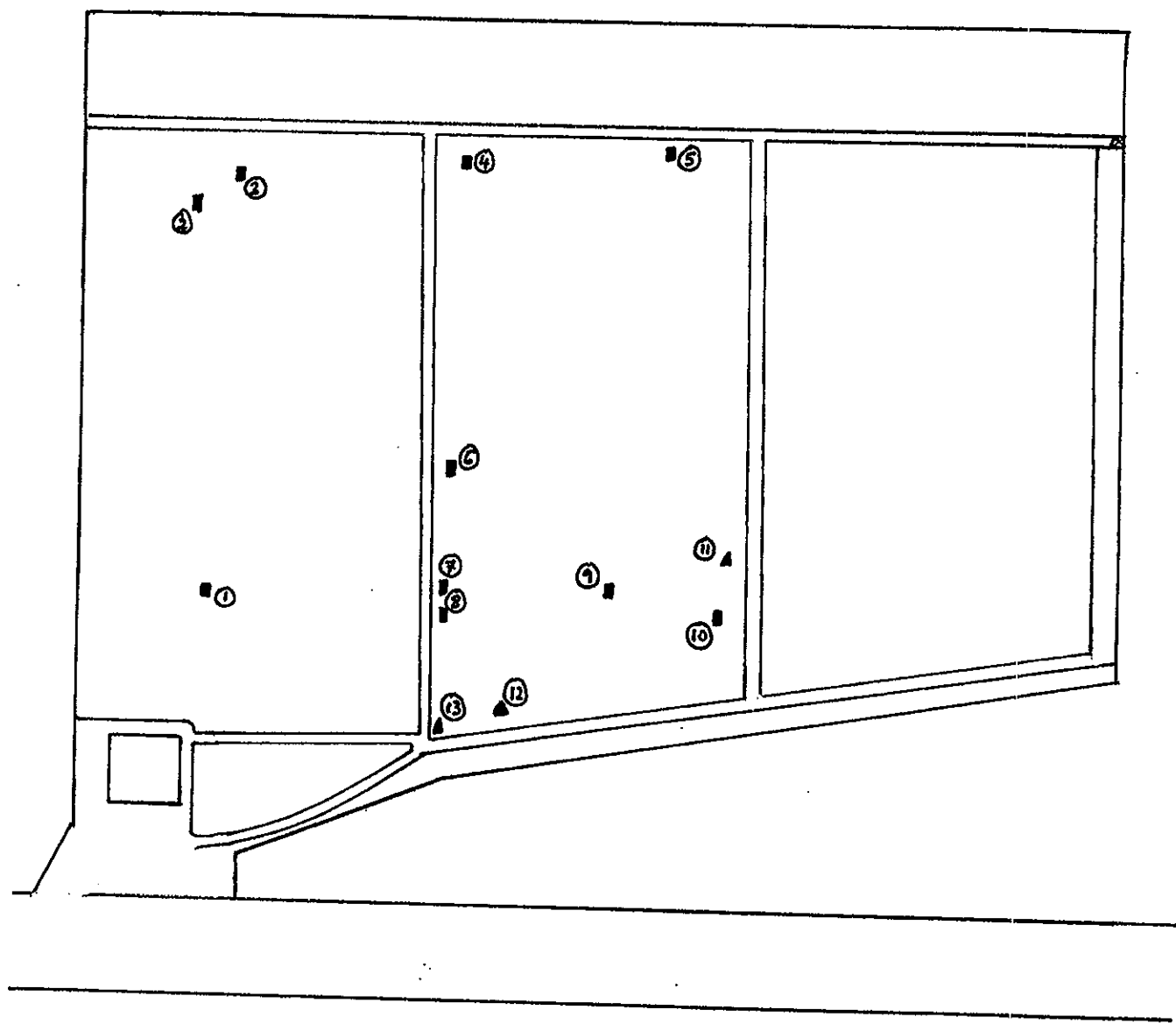



Inspection Format

Cemetery ID: 10270

County: SURREY

Last Inspection Date: 09/07/2009

Overall Risk Assessment:

Cemetery Name: FARNHAM (BADSHOT LEA) CEMETERY

OS Map Ref: 186/859485

Works Features:

Category: 1

Order

No	Casualty Name	Location	Marker	Material	Nationality	War	Add. Bur.	Main-tained	Remarks
SECTION A									
10	CLANCY T W	128	CH	Portland		WW2	0		Turfed flat

10270

FARNHAM (BADSHOT LEA) CEMETERY

SURREY

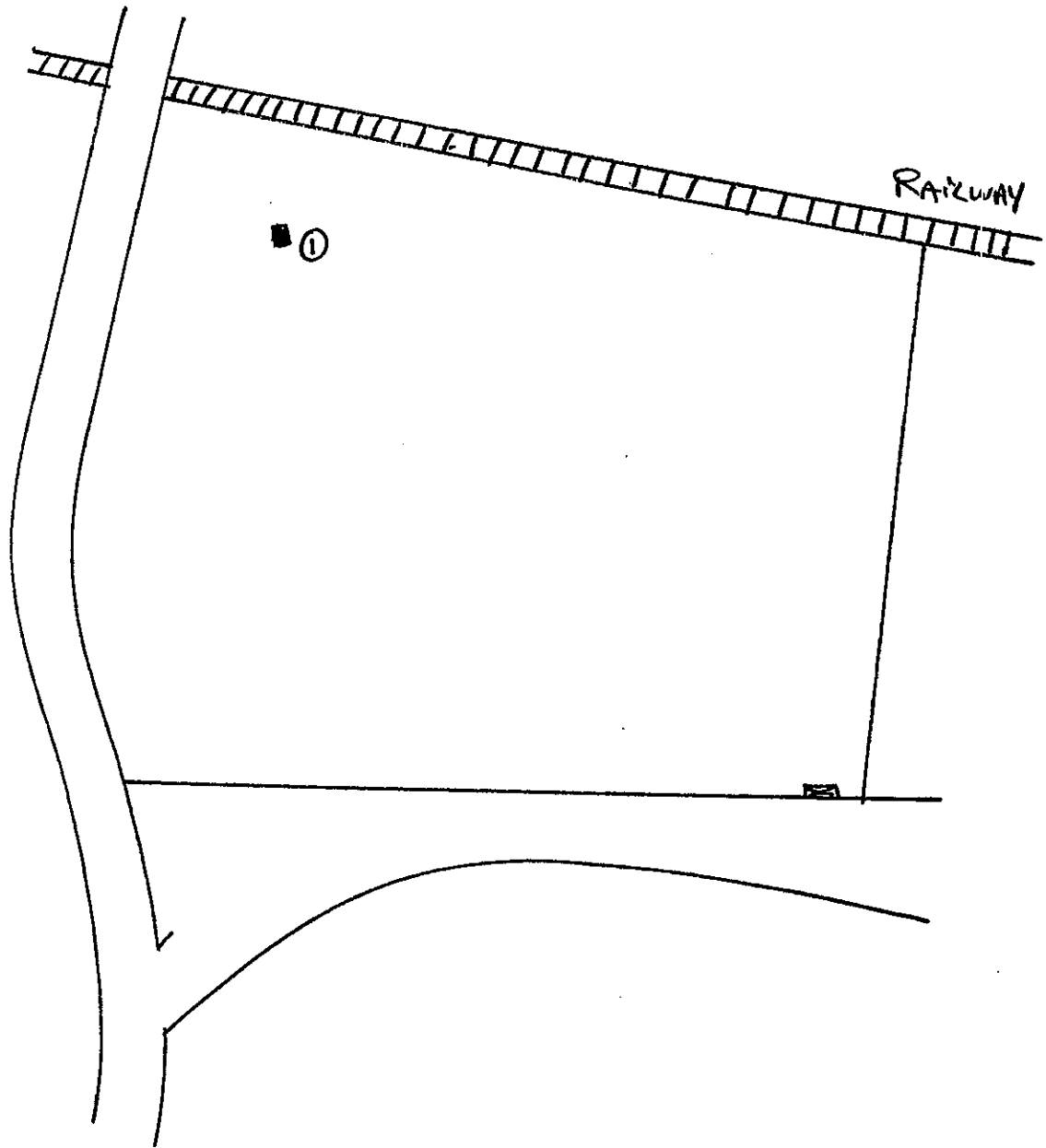



Inspection Format

Cemetery ID: 10271

County: SURREY

Last Inspection Date: 09/07/2009

Overall Risk Assessment:

Cemetery Name: FARNHAM CIVIL CEMETERY

OS Map Ref: 186/831466

Works Features:

Category: 1

west street

Order

No	Casualty Name	Location	Marker	Material	Nationality	War	Add. Bur.	Main-tained	Remarks
10	STACEY J	N.4351	CH	Portland		WW1	0		Flat turf
20	DOUGHTY C	N.4211	CH	Portland		WW1	0		Flat turf
30	MOULE W G	N.4114	CH	Portland		WW1	0		Flat turf
40	PARSONS J	N.4172	CH	Portland		WW1	0		Flat turf
50	LORD A C J	N.4216	CH	Portland		WW1	0		3 rows forward, 1 left of CH to PRESTON
60	PRESTON T	N.4204	CH	Portland		WW1	0		Flat turf
70	WEBB H	N.4163	CH	Portland		WW1	0		Flat turf
80	CROPP E	N.4121	CH	Portland		WW1	0		Flat turf
90	PORTSMOUTH W H	N.4094	CH	Portland		WW1	0		Flat turf
100	CONNOR B A J	M.3545	CH	Portland		WW1	0		Flat turf
110	SMITH A J	M.3571	CH	Portland		WW1	0		Flat turf
120	COPE C	M.3963	CH	Portland		WW1	0		Flat turf
130	HANHAM P B	M.3900	PM			WW1	1		4'6" grey granite cross & kerb (inscribed with vase only). Turf infill. 7 rows back, 5 right (by path) of CH to COPE
140	WARNER A E	M.3989	CH	Portland		WW1	0		Flat turf
150	JEFFERY H W	M.3904	CH	Portland		WW1	0		Flat turf
160	LOWMAN W S	M.3734	PM			WW1	2		4'6" york headstone & kerb (un-inscribed) and open book. Turf infill. Double grave space. 2 rows forward, 11 right of CH to JEFFERY.
170	WILLIAMS C V W	C.1332	CH/PM	Portland		WW2	2		CH and 5'6" white marble headstone (commemorating 2 other). Double grave space. White marble kerb (uninscribed). Turf infill.
180	CARTER W G	C.1411	CH	Portland		WW1	0		Flat turf
190	WALLACE J Baden-Powell	L.691	CH	Portland		WW1	0		Flat turf
200	PURCHASE A J	L.664	PM			WW1	1		4'6" portland headstone. Flat turf. 1 row back, 2 right of CH to WALLACE.
210	JOSEPH A E	Q.876	CH	Portland		WW1	0		Flat turf
220	FOLEY P	Q.810	CH	Portland		WW1	0		Flat turf



Inspection Format

230	STAHL H C	P.4694	PM		WW1	0	4' grey granite rock faced block and kerb. Chippings. (Next 6' grey granite cross SMITH). Along wall dividing cemetery in old part, 14th grave from top path into new part of cemetery.
240	LLOYD M	P.4672	PM		WW1	2	6' white marble cross (on 3 tier base). 4 space grave - kerb (un-inscribed). Turf infill. 6 rows behind CONNOR. Row against dividing wall & top left of entrance in newer part of Cemetery.

SECTION X

250	LUCKHURST A	X.1	CH	Portland	WW2	0	Flat turf. (In Row of 6)
260	THOMPSON F A	X.2	CH	Portland	WW2	0	Flat turf
270	COX S B	X.3	CH	Portland	WW2	0	Flat turf
280	KEAREY S W	X.4	CH	Portland	WW2	0	Flat turf
290	AMEY J	X.5	CH/PM	Portland	WW2	0	Portland kerb un-inscribed. Turf infill. (In Row of 6)
300	GRAVES R	X.6	CH	Portland	WW2	0	Flat turf
310	HAYTER S J	X.68	CH/PM	Portland	WW2	1	CH & portland kerb (inscribed). Double space.
320	BARTLETT P L	X.296	CH/PM		WW2	1	York kerb (inscribed). Chippings infill.
330	COPSEY W V	X.454	CH	Portland	WW2	0	Turf flat
340	RANSON T	X.469	PM		WW2	0	Grey granite 1'6" headstone & kerbs (un-inscribed). Turf infill. Same row. 15 left of CH to COPSEY

SECTION V

350	COLLINS J F	V.1228	CH	Portland	WW2	0	Flat turf
-----	-------------	--------	----	----------	-----	---	-----------

SECTION W

360	PIERCE F E	W.48	CH	Portland	WW2	0	Flat turf
370	STEVENSON A	W.92	PM		WW2	0	4' white marble headstone & kerb (un-inscribed). Chippings. 1 row back, 7 left of CH to PIERCE.
380	ROBINS N W	W.259	PM		WW2	2	(2) 1'6" portland headstone on double grave space. Kerb (uninscribed) and chippings. War casualty on one headstone.
390	JEPP D W C	W.449	PM		WW2	3	3' white marble headstone. Un-inscribed kerb - chippings.
400	ALLEN D B	W.452	PM		WW2	2	1'6" portland headstone. Uninscribed kerb & chippings.

FARNHAM CIVIL CEMETERY

SURREY

